

Bench Seat: SB1

The SB1 Bench Seat is a great example of simple, ultramodern design. Manufactured in laser cut steel with timber slats, the SB1 has been ergonomically designed to give a comfortable seating position.

All seats have been designed to give optimum strength and durability. The SB1 is made of the highest quality imported Kwila, suitably seasoned and treated with a double stain and high quality clear coat for durability and enhanced natural appearance.

- Dimensions**
- Seat height: 485mm
 - Seat length: 1703mm
- Materials**
- Laser cut steel
 - Kwila timber battens 44mm x 32mm
 - Aluminium battens as an option
- Finishes**
- Hot spray galvanised
 - Available in a variety of powder coated colours
 - All Timber Battens are double stained and clear coated with weather protection coating.
- Options**
- Aluminium battens
 - Stainless steel body

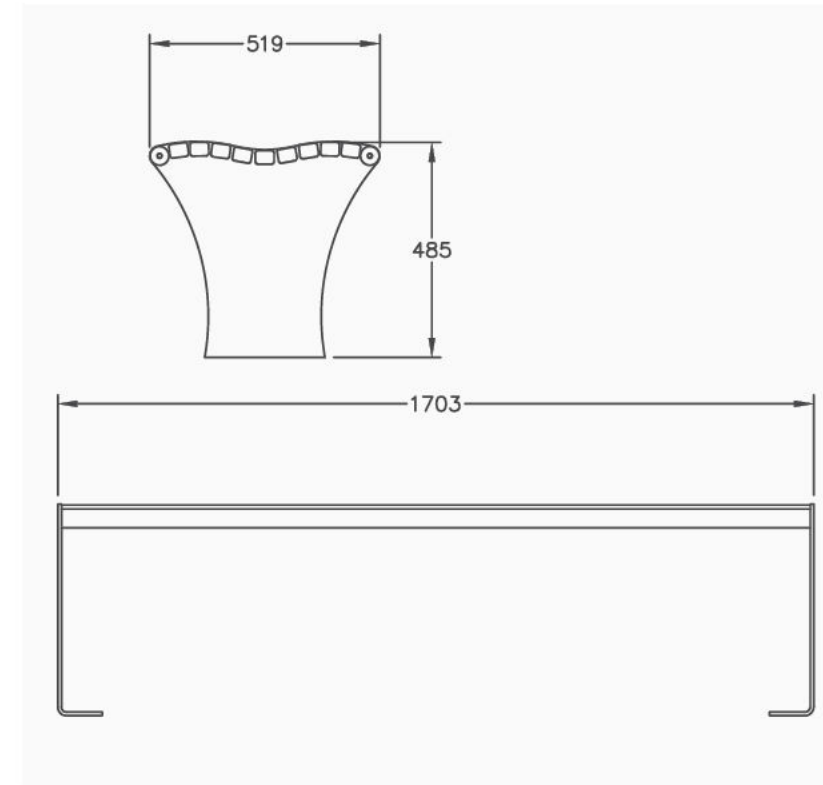

[Click to view the latest SB1 projects online](#)

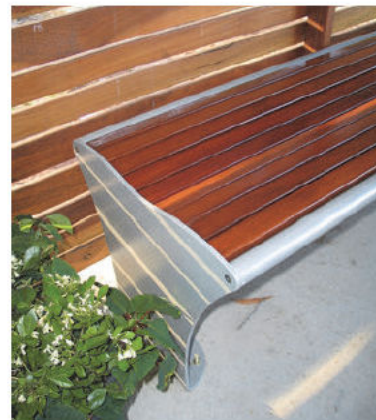

Get the latest specification news on



www.urbanff.com.au

07 3382 7372

info@urbanff.com.au

Urban
fountains + furniture